

## Outline of non-interruptible switching method

"Non-interruptible switching method" is a switching method that can switch the load of an existing UPS to a new UPS without any interruption or power failure by using a non-interruption switching device.

As following are the concept of the non-interruptible switching method with a simplified diagram.

### 1 Before power supply switching ( Existing UPS power supply )

Power is being supplied to the load equipment and distribution panel from the existing UPS power supply. — : Existing cable

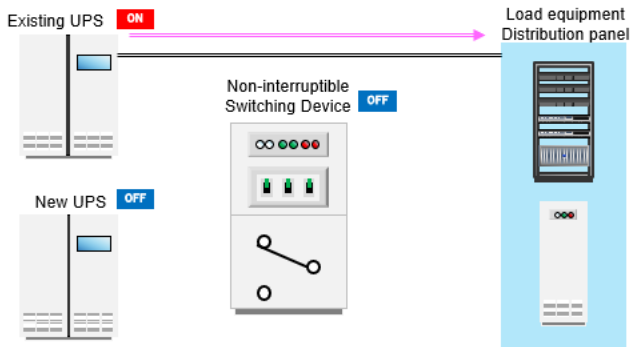

### 2 Connection of Non-interruption switching Device

The loop power supply is configured between the existing UPS and the load equipment / distribution board via the non-interruptible switching Device. — : Existing cable, - - - : Temporary cable

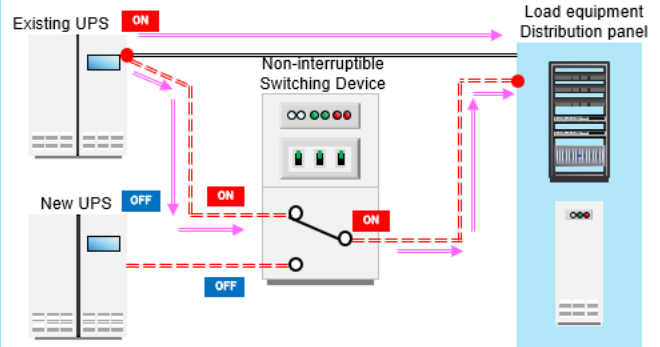

### 3 Switch without interruption → New cable connection → Remove temporary cable and Non-interruptible Switching Device

Performs Non-interruptible switching between the existing UPS power supply and the new UPS power supply. - - - : Temporary cable, - - - : New cable

After connecting the new cable between the new UPS and the Load equipment / Distribution Panel, remove the temporary cable.

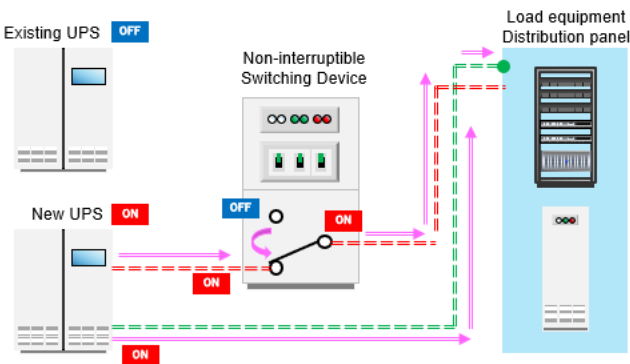

### 4 After power supply switching ( New UPS power supply )

Power is being supplied to the Load equipment and Distribution panel from the new UPS power supply. - - - : New cable

